



**PB-US62**

---

## **COMPACT AMPLIFIED SUBWOOFER**

# **Owners Manual**

*Please read through this manual to familiarize yourself with your compact amplified subwoofer. Should your PowerBass speaker system ever require service, you will need to have the original dated receipt.*





### Thank you and Congratulations

Congratulations on your purchase of a PowerBass speaker system. You now own a speaker of uncompromising design and engineering from a factory that truly believes in the relentless pursuit of perfection. Incorporating the highest quality parts and state-of-the-art materials, these speakers display the ultimate balance between high fidelity, performance and long-lasting reliability.



At PowerBass USA, Inc. we are confident you will have many years of outstanding enjoyment from this great SPEAKER investment. For maximum performance we recommend that you have your new PowerBass Autosound product installed by an Authorized PowerBass Autosound Dealer.

To learn more about PowerBass, please visit us on the World Wide Web at  
<http://www.powerbassusa.com>

#### Δ Warning Δ

Continuous exposure to sound pressure levels in excess of 100 dB can cause permanent hearing loss. PowerBass Autosound Speakers are capable of producing sound pressure levels well over 170 dB. Please observe all local sound ordinances while listening to your PowerBass Autosound system. PowerBass USA, Inc. accepts no liability for hearing loss, bodily injury, or property damage due to the result of use or misuse of this product.

## POWERBASS COMPACT AMPLIFIED SUBWOOFER

**BUILT-IN HIGH POWERED AMPLIFIER:** Contains a high power Class D monaural amplifier complete with chassis mounted adjustable Low Pass Filter and Bass Boost controls for sonic integration into most existing factory or aftermarket car stereo systems and engineered perfectly to power the subwoofer.

**SELECTABLE SENSITIVITY SETTING:** When the input selection is switched to SPK. and this switched to high , the preamp sensitivity will accept input voltages from 2V-10V. This will be used if High Level Inputs are connected to your amplified enclosure.

When the input selection is switched to RCA. and this switched to NOR , the preamp sensitivity will accept input voltages from 250mV-6V. This will be used if Low Level RCA Inputs are connected to your amplified enclosure.

**REMOTE SUBWOOFER LEVEL CONTROL:** This wired remote functions as the amplifier's gain circuit and can be adjusted from the driver's seat. A Status LED Light illuminates for visual confirmation of correct operation mode or if an issue is detected.

**DUAL 6" WOOFERS\*:** Dual 6in \*(measured diagonally) Oval Subwoofers featuring a thermoplastic polymer cone which was selected to help resist moisture and other elements while the rubber surround offers more excursion as well as protection against deterioration than other materials..

**KSV HIGH TEMPERATURE VOICE COIL:** These specially designed resin coated high temperature Kapton® voice coils measure 1 1/2 inches in diameter to ensure high power handling and precise linear excursion while maximizing thermal heat dissipation.

**AUTO TURN-ON CIRCUIT:** When using the high level inputs, the amplifier will turn on automatically when it senses a signal from your radio.

*Kapton® is a registered trademark of E.I. du Pont de Nemours and Company*

# SPECIFICATIONS FOR PB-US62 SUBWOOFER SYSTEM

(Due to Constant Improvements, Specifications and Parameters are subject to change without notice.)

Size	System Impedance	Frequency Response	Sensitivity 1W/1M	Magnet Size	Voice Coil Dia.	Low Level Input Sensitivity	High Level Input Sensitivity	Amp Power RMS/Peak
Dual 6"	2-ohm	20Hz-200Hz	95dB	20 oz.	1.5"	250mV - 10V	1.0V - 10V	50W/150W

## UNPACKING THE ENCLOSURE

Every attempt has been made to transport your new PowerBass PB-US62 subwoofer system safely. Carefully unpack the enclosure and inspect it thoroughly for any damage that may have occurred during shipping. Notify your local PowerBass dealer immediately should you notice any damage prior to installing the unit. Be sure to keep the carton and packing material until your system is operational. The original boxes will do the best job of protecting your speaker system if they need to be transported.

## INSTALLATION EXPERIENCE

Installation of PowerBass Autosound Speakers requires experience with a variety of mechanical and electrical procedures. This manual only provides general installation and operating instructions. If you have any reservations about your installation skills or lack the proper tools, please contact your local PowerBass Autosound dealer for assistance.

**IMPORTANT: This amplified subwoofer system is designed for operation in vehicles with 12-volt Negative ground electrical systems only.**

## ENCLOSURE PLACEMENT TIPS & RECOMMENDATIONS

Your Powerbass Amplified Bass system must be properly placed in the vehicle for optimum performance. Find a spot under your seats where the enclosure will not get in the way of any moving parts of the seat. Make sure that the seat moves freely if it is adjustable.

**WARNING:** Make sure where ever you choose to place the enclosure it's a dry location on a solid surface. Take care that none of the mounting screws will pierce any wiring harnesses, brake or fuel lines, the vehicles fuel tank, spare tire or any other parts of the vehicle. Some or all of these may be located behind or under the mounting surface.

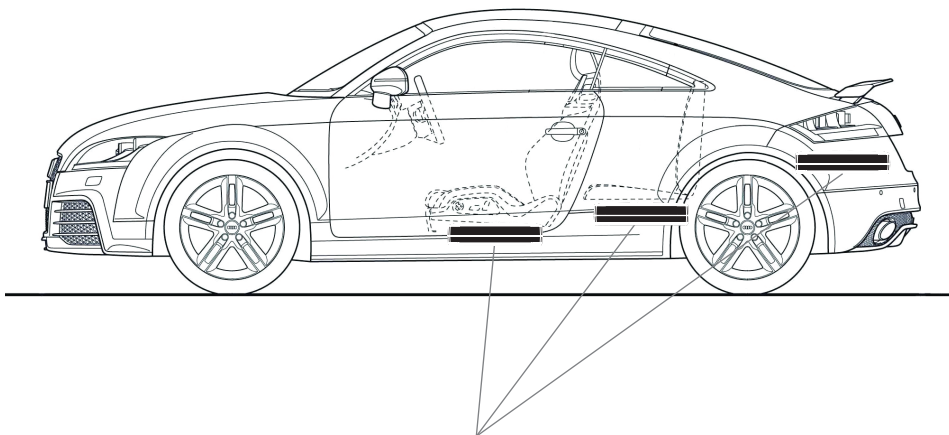
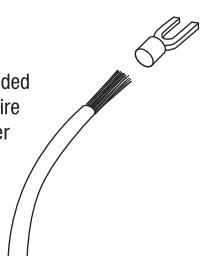
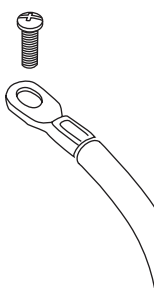

Fig.1 Possible locations for installation



### CONNECTIONS TO AMPLIFIER FOR BATT+, GND and REM

For maximum transfer of Voltage it is highly recommended to attach insulated Ring and/or Spade terminals to wire ends connecting to the amplifier for Power Connections. These terminals (not supplied) should be soldered or at the very least crimped to the wire—make sure no wire strands stray outside the terminal barrel.

# ENCLOSURE DIMENSIONS AND SPECIFICATIONS

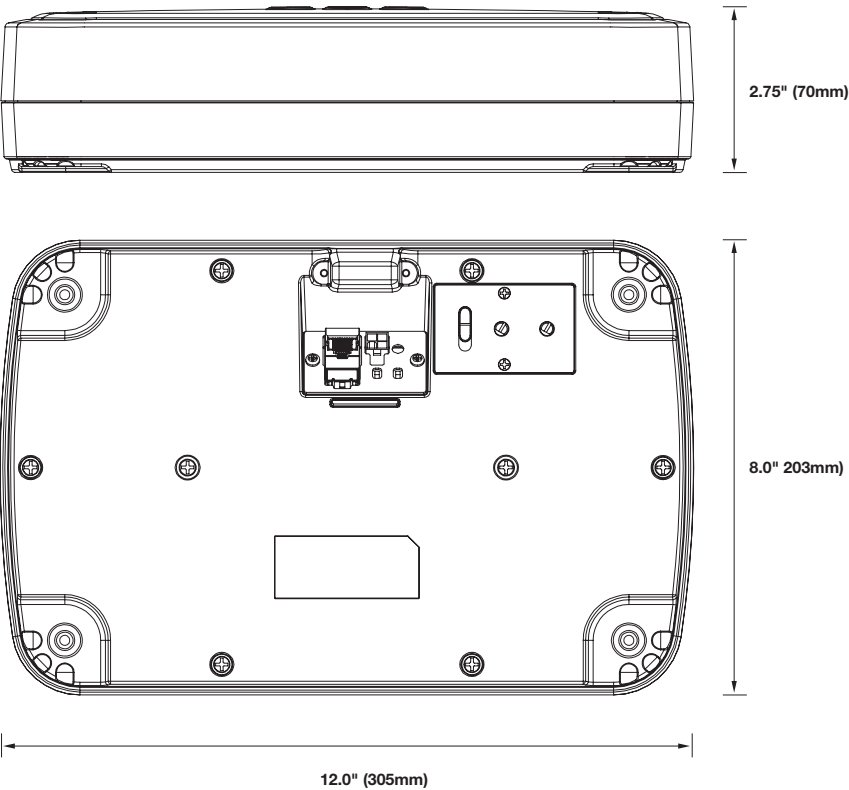

**NOTE:** The speaker system must be secured to protect the enclosure from moving. Before final mounting, be sure to check the sound one last time and make sure the enclosure is properly placed to produce the desired bass output. Use the four mounting feet and screws provided.

## PB-US62 CONTROL PANEL LAYOUT

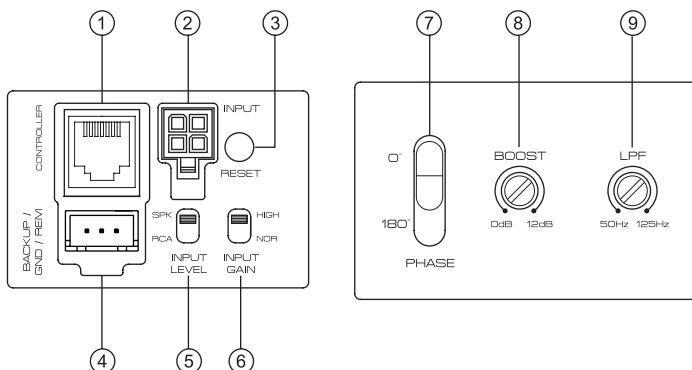

Fig.2

### 1. CONTROLLER - REMOTE LEVEL

This is the connector port for the Remote Level control. Now the amplifiers secondary gain circuit can be adjusted from the driver's seat.

### 2. INPUT PLUG

Use the High Input 4-pin Molex style jack with RCA type connectors for use with an aftermarket head unit. When connecting to the speaker leads directly from a factory radio without the use of a low level converter. Cut the RCA connectors off and proceed to hardwire to the factory speaker wires. Be sure to observe the correct speaker polarity.

### 3. RESET

Microprocessor Reset Button for use only when the unit fails to provide output and needs to be reset press and hold for 3 seconds until the unit power cycles.

### 4. POWER INPUT PLUG

#### BATT+ (12 Volt Positive)

This terminal is the main power input for the amplifier and must be connected directly to the positive (+) terminal of the battery.

#### REM (Remote)

The amplifier in your PB-US62 enclosure can be turned on by applying 12 volts to this lead. This can be on the rear of the source unit (radio) in the form of an output or remote output. If this is not available you can wire up to the ACC position on the ignition key switch.

**NOTE:** If using the high input, the amplifier will turn on automatically when it senses a signal from your radio. You will not have to hook up the REM wire in this case.



**GND (Ground Input Connection)**

A good quality ground is required for the amplifier to operate a peak performance. This should be attached directly to the chassis of the vehicle. Make sure that all of the paint is sanded or scraped away to ensure a good quality ground connection.

**5. INPUT LEVEL SWITCH**

Used to select which type of input will be used. Switch to RCA when using Low Level RCA input, switch to SPK when using High Level inputs from your factory headunit.

**6. INPUT GAIN SWITCH**

Used to select which level input will be used. With this switched to Normal, the preamp sensitivity will now accept 250mV-6V. When switched to High the preamp sensitivity will now accept 2V-10V.

**7. PHASE Switch**

This switch will reverse the phase of the speaker output without having to touch any wiring. 0 is normal. 180 reverses the output. Select whichever setting provides the most bass in your application.

**8. BASS BOOST Control**

This equalization circuit is used to enhance the low frequency response of the vehicles interior. With up to 12dB of boost centered at 45Hz the Bass Boost can be adjusted to meet your personal taste. Please note that by boosting the Bass Boost to its full +12dB you are asking the amplifier to work 10 times harder!

**9. LPF (Low Pass Filter) Control**

This filter allows the low pass of frequency and has an adjustable crossover point from 40Hz to 200Hz. A setting of 40Hz will produce only the low frequencies (deep bass). A max setting of 200Hz will allow the amplifier to produce a more punchy (higher) bass response.

# POWER WIRING AND SIGNAL CONNECTIONS

## POWER CONNECTION

**BATT+** The amplifier should be wired directly to the vehicle battery. If factory grommets are not available, install grommets yourself to protect the cable from sharp metal edges.

**REM** Run 18ga wire (not included) to the radio lead or remote output. This wire is responsible for turning the amplifier on and off. If the source unit (radio) is not equipped with a Remote lead, you can connect this wire to an accessory or ignition point at the vehicle fuse block. In this type of installation, the amplifier will be on whenever the ignition is on.

**GND** GND Connect the ground wire to the nearest bare-metal surface on the vehicle. Keep the length of the ground cable to an absolute minimum using a spade terminal at the amplifier end and a ring terminal as shown in below at the chassis end (Fig 3).

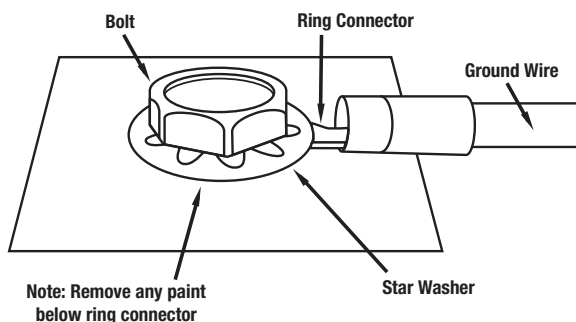

Fig.3

## **INPUT SIGNAL (CHOOSING THE HIGH OR LOW INPUTS)**

The PB-US62 amplifier input signal connects to the head unit's High Level (speaker wire) output OR Low Level (RCA) output—provided the radio is so equipped with Line Out. A dedicated subwoofer or low level signal will deliver the best performance. If unavailable use the high level inputs, as will be the case with most factory head units. (Note once you have chosen whether you will use the High Level or Low Level inputs follow the corresponding wiring diagrams on the following pages)

### **High Level Input Connections** (fig 4)

For radios with only speaker outputs (including most Factory source units). Using the 4-pin Molex style wiring harness provided, cut off the RCA Connectors and splice directly into the radio's speaker outputs. Do not break the connection with the source (radio) and the speakers. Be sure to maintain proper speaker polarity.

<u>Wire Color</u>	<u>Connect to</u>
<b>Gray</b>	<b>Left +</b>
<b>Gray w/ Black Stripe</b>	<b>Left -</b>
<b>White</b>	<b>Right +</b>
<b>White w/ Black Stripe</b>	<b>Right -</b>

Another option is to tap off the existing front or rear full range speakers. Once again be sure to follow the correct polarity.

**NOTE:** If using the high input, the amplifier will turn on automatically when it senses a signal from your radio. You will not have to hook up the REM wire in this case.

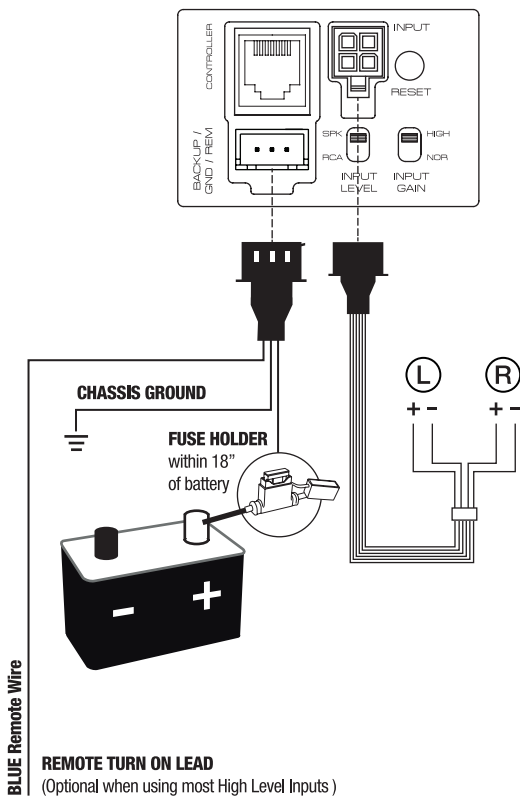

Fig.4 High Level Connections

**Low Level Input and RCA Interconnect Wiring (fig 5)**

For radios that have RCA line outputs. You will need to connect the low-level RCA style inputs from the PB-US62 to the line-outputs from the radio (source) via an RCA interconnect commonly called a “stereo patch cord”. Choose the correct length and style of RCA interconnects for your needs. Always use high quality RCA audio cables (not supplied) for signal connections—those with multiple layers of shielding or a twisted pair variety for better noise rejection.

Be extra careful when routing your RCA audio interconnect cables. Car environments are notorious for poorly insulated wires. This means that hiss, engine noise and fan noise can be easily picked up through RCA cables if run incorrectly. Take care to make sure the power and audio signal are not on the same side of the vehicle and they do not cross each other.

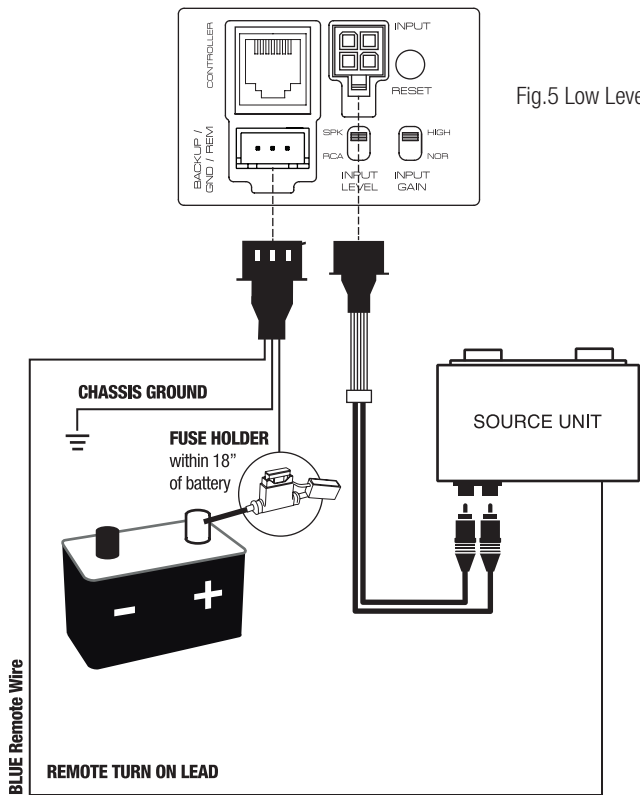

Fig.5 Low Level Connections

## SET UP ADJUSTMENTS

Your PB-US62 uses several controls to provide sonic integration with virtually any vehicles unique acoustic properties. Please read the following section carefully to familiarize yourself with the function of each control. The following adjustment sequence is recommended to properly tune your PB-US62.

By adjusting the LPF, then the PHASE switch, followed by the BASS BOOST (in this order) will give you the best results. Once Set you can use the dash mounted GAIN control to set your desired output level.



Fig.7 Low Pass Control (LPF)

### LPF (Low Pass Filter) Crossover Adjustment

Since musical tastes vary, adjust the crossover by ear while listening to the music of your choice. Turn the crossover LPF adjustment all the way down to 50Hz. Then slowly turn the knob up until desired sound is achieved. Normal listening level should be right around 80Hz to 125Hz.

Use common sense when adjusting the crossover. When properly adjusted, the bass from the PB-US62 should blend in with the rest of your speakers and not overpower the music. Be sure to set the tone controls of your radio (source unit) to flat while dialing in the crossover. (Fig 7)

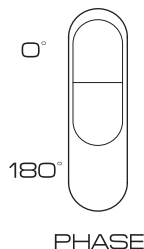

Fig.8 Phase Switch

### Setting the PHASE switch

Start with the PHASE switch set at 0° and play a favorite music track that contains some solid bass (make sure the BASS EQ control is set at the 12 o'clock position). Then flip the switch to 180° and listen to the same musical track again. Choose the setting that provides the best bass response according to your taste.

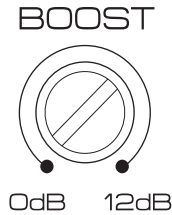

Fig.9 Boost Bass EQ Control

### BASS BOOST Adjustment

This special feature is designed to provide you with more powerful sound quality and it allows you to increase the Bass up to +12dB. Keep in mind that more is not always better. Adjusting the control to the MAX (12dB) position will stress the amplifier and the woofer which could result in damage. (Fig 9)

**NOTE:** Although this adjustment sequence will in most cases provide the best tuning results, the actual process may include several readjustments of each of the controls since their settings interact with each other. If necessary, consult your Authorized PowerBass dealer for help tuning your system.

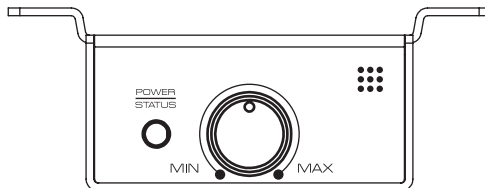

Fig.10 Remote Level Controller

### Remote Level Controller

Your PowerBass STA enclosure includes a wired Remote Level Subwoofer control module. To connect the Remote Subwoofer Gain control to the amplified enclosure, simply insert a RJ45 ethernet jack into the REMOTE gain port. Mount the module within easy reach or under your dash. (Fig 10)

**NOTE: DO NOT PLUG IN OR DISCONNECT the remote bass level controller when the amplifier is on!**

### Break In Period

To get the most from your woofer we recommend a "break-in" period of at least 40 hours (typically 2 weeks) at no more than 1/3 of maximum volume.

During this time the cone and spider assembly will gradually break in resulting in greater performance and more listening enjoyment.

# TROUBLESHOOTING TIPS

Problem	Solution
<b>Power BLUE LED not ON</b>	With a Volt OHM Meter (VOM) check: <ul style="list-style-type: none"><li>• +12 Volt power terminal (should read +12 to +16VDC)</li><li>• Remote turn-on terminal (should read +12 to +16VDC)</li><li>• Ground Terminal</li></ul>
<b>Power LED lights BLUE, no output</b>	<ul style="list-style-type: none"><li>• Check RCA connections</li><li>• Substitute known good Source Unit</li><li>• Check for signal on the RCA cable with VOM in AC position</li></ul>
<b>The RED LED is ON, no output and</b> <b>1. Amp is VERY HOT</b>  <b>2. Amp shuts down ONLY when the vehicle is running</b>	<ul style="list-style-type: none"><li>• Thermal protection is engaged. Check for proper impedance at speaker terminals. Also check for adequate air flow around the amplifier.</li><li>• Voltage protection engaged. Voltage to the amp is not within the 10-16 VDC operating range. Have the battery/charging system inspected.</li></ul>
<b>RED Clip LED is ON</b>	<ul style="list-style-type: none"><li>• Readjust your Gain or Bass EQ settings to where the Clip indicator flashes during heavy bass notes.</li><li>• If the Clip indicator is constantly on this means the output of the amplifier is now distorted and needs to be readjusted.</li></ul>
<b>Alternator noise (varies with RPM)</b>	<ul style="list-style-type: none"><li>• Check for damaged RCA cable.</li><li>• Check routing of RCA cable</li><li>• Check Source Unit for good ground</li><li>• Check amp gain setting, turn down if set too high</li></ul>



**Product Disposal** – Certain international, national and/or local laws and/or regulations may apply regarding the disposal of this product. For further detailed information, please contact the retailer where you purchased this product or the PowerBass Importer/Distributor in your country.



## **WE WANT YOU LISTENING FOR A LIFETIME**

Dear Customer,

Selecting fine audio equipment such as the speakers you've just purchased is only the start of your musical enjoyment. Now it's time to consider how you can maximize the fun and excitement your equipment offers. PowerBass and the Consumer Electronics Association (CEA) want you to get the most out of your equipment by playing at a safe level. One that lets the sound come through loud and clear without annoying, blaring or distortion- and, most importantly, without affecting your sensitive hearing.

Sound can be deceiving. Over time your hearing "comfort level" adapts to higher volumes of sound. So what sounds "normal" can actually be loud and harmful to your hearing. Guard against this by setting your equipment at a safe level BEFORE your hearing adapts.

PowerBass and the CEA want you to listening for a lifetime!



# POWERBASS AUTOSOUND LIMITED WARRANTY POLICY

PowerBass USA, Inc. offers limited warranty on PowerBass products under normal use on the following terms:

**PowerBass Autosound Speakers are to be free of defects in material and workmanship for a period of one (1) year.**

This warranty applies only to PowerBass products sold to consumers by Authorized PowerBass Dealers in the United States of America. Products purchased by consumers from a PowerBass dealer in another country are covered only by that country's Distributor and not by PowerBass USA.

This warranty covers only the original purchaser of PowerBass product. In order to receive service, the purchaser must provide PowerBass with the receipt stating the consumer name, dealer, product and date of purchase.

Products found to be defective during the warranty period will be repaired or replaced (with a product deemed to be equivalent) at PowerBass's discretion and will not be liable for incidental or consequential damages. PowerBass will not warranty this product under the following situations:

- **Amplifiers received with apparent rust or corrosion**
- **Any evidence of liquid damage or exposure to excessive heat**
- **Abuse such as holes in the cone, surround or ripped spider**
- **Voice coil damage due to amplifier clipping or distortion**
- **Product that has not been installed according to this owners manual**

Any implied warranties including warranties of fitness for use and merchantability are limited in duration to the period of the express warranty set forth above. Some states do not allow limitations on the length of an implied warranty, so this limitation may not apply. No person is authorized to assume for PowerBass any other liability in connection with the sale of this product.

**Please call (909) 923-3868 for PowerBass Customer Service.** You must obtain an RA# (Return Authorization Number) to return any product to PowerBass. **The RA number must be prominently marked on the outside of the shipping carton or the delivery will be refused.** Please pack your return carefully; we are not responsible for items damaged in shipping.

Residents of HI, AK and US territories will be charged for return shipping. All inquiries regarding service and warranty should be sent to the above address.





PowerBass Autosound – A division of PowerBass USA, Inc.

2133 S. Green Privado – Ontario, CA 91761

Tel. (909) 923-3868 – Fax (909) 923-8048

**[www.powerbassusa.com](http://www.powerbassusa.com)**